



Changing Default APPs in Windows 10

Description: The district has 'default APPs' pinned to the start menu of your computer. You can use the settings feature to change the default APPs in the start menu. To do this, follow the steps below.

Directions for Use:

Start by typing the word 'settings' into the search bar on the task bar as shown below.

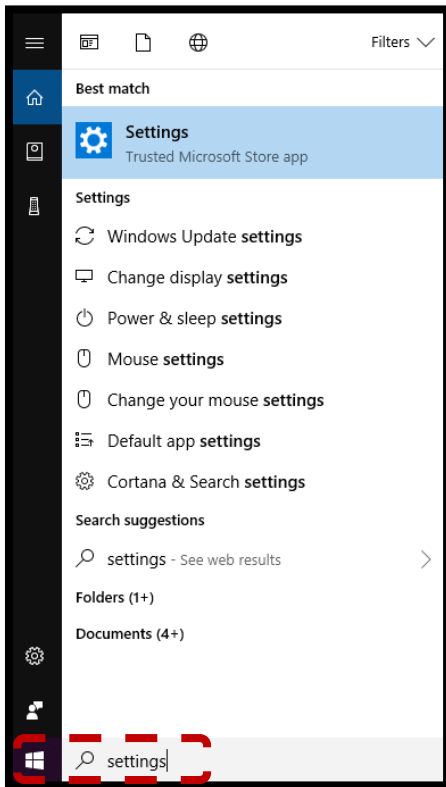

Once in settings, click on the APPs choice:

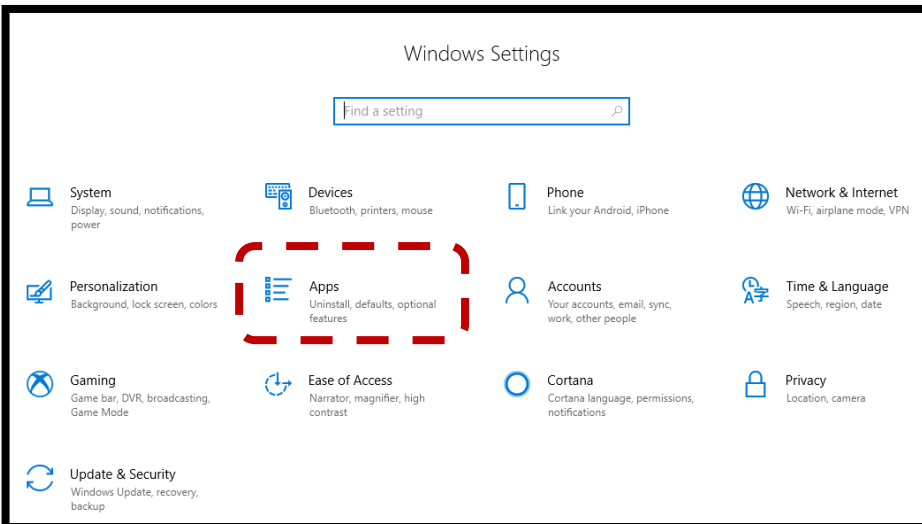



Changing Default APPs in Windows 10

Find 'Default APPs' located on the left side of the screen in purple:

The screenshot shows the Windows 10 Settings application. The left sidebar is purple and contains the following options: Home, Find a setting, Apps, Apps & features, **Default apps** (highlighted with a red dashed box), Offline maps, Apps for websites, Video playback, and Startup. The main content area is titled 'Apps & features' and includes sections for 'Installing apps', 'Apps & features', and a list of installed applications. The 'Installing apps' section has a dropdown menu set to 'Allow apps from anywhere'. The 'Apps & features' section has a search bar and sorting options. The list of installed applications is as follows:

App Name	Developer	Size	Installed Date
Adobe Acrobat DC	Adobe Systems Incorporated	2.28 GB	2/27/2018
App Installer	Microsoft Corporation	16.0 KB	5/7/2018
Calculator	Microsoft Corporation	16.0 KB	8/21/2018
Dropbox	Dropbox, Inc.		8/15/2018
Get Help	Microsoft Corporation	16.0 KB	7/23/2018

Once you've clicked on 'Default APPs', you can select how you want to add or delete the default APPs that appear in your start menu. You can scroll to the bottom of that window and select how you want them added. You can reset them to Microsoft's default APPs, Choose default APPs by protocol, or set defaults by APP. Once you've selected which APPs you want to appear in your start menu, the APPs that you've selected will appear at the top as defaults.